

3.1 HW19710变速器及其操纵/Transmission & Control System

序号/ No.	名 称 / Designation	页 码 /Page No.
3.1.01	变速器前壳组件/Transmission Front Housing	1
3.1.02	变速器中壳组件/Transimission Housing -Middle	2
3.1.03	输入轴及端盖组件/Imput Shaft and Cover	3
3.1.04	副轴组件/Auxiliary Shaft	5
3.1.05	主轴组件/Main Shaft	7
3.1.06	惰轮轴组件/Idle Wheel	9
3.1.07	范围档副箱组件	10
3.1.08	小盖组件/Small Cover	17
3.1.09	拨叉轴组件/Fork Shaft	21
3.1.10	油泵及管路组件/Pump and Pipe	22
3.1.11	气动管路阀组件/Air Pipe and Valve	24
3.1.12	变速器操纵附件（双杆, 拉式）/Shifting Accessories	26
3.1.13	电器开关组件（电磁式传感器）/Electric Switch	27

3.1.14	标牌组件	-----	28
--------	------	-------	----

3.1.01 变速器前壳组件/Transmission Front Housing

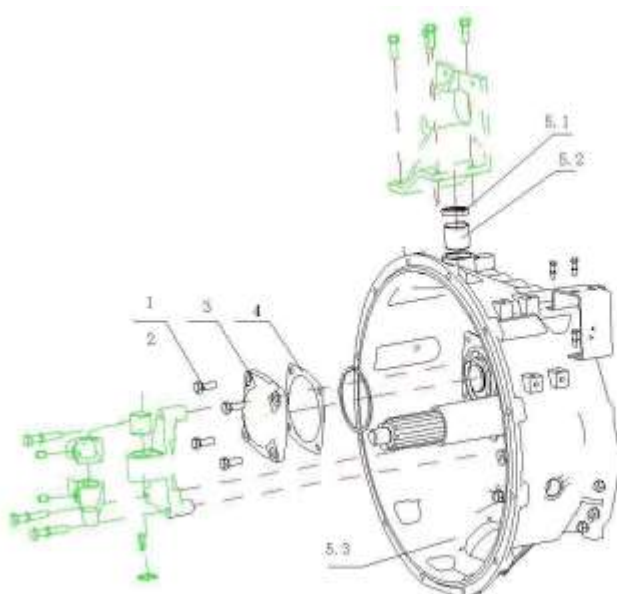

3.1.01 变速器前壳组件/Transmission Front Housing

序号 No.	零部件图号 Part No.	名称	Part Name	数量 Qty	备注 Remark
-	AZ2201000247	变速器总成	Transmission ass.	1	
1	Q150B1030	六角头螺栓	Screw	4	
2	Q40310	弹簧垫圈	Washer	4	
3	WG2222000001	副轴端盖	Cover	1	
4	WG2229000002	副轴端盖衬垫	Gasket	1	
5	AZ2203000001	变速器前壳总成	Transmission Front Housing	1	
5.1	WG2229003030	复合衬套 (DX) 30×34×	Bush	1	
5.2	WG9003073001	骨架油封PS 30 45 8	Oil sealing	1	From 20110308
5.2	AZ9003073001	骨架油封PS 30 45 8	Oil sealing	1	To 20110308
5.3	AZ2220000201	变速器前壳	Transmission Front Housing	1	From 20110308
5.3	AZ2220000001	变速器前壳	Transmission Front Housing	1	To 20110308
6	WG2229000001	变速器前壳衬垫	Gasket	1	
7	Q341B10	1型六角螺母-细牙	Nut	25	
8	Q40310	弹簧垫圈	Washer	25	

3.1.03 输入轴及端盖组件/Imput Shaft and Cover

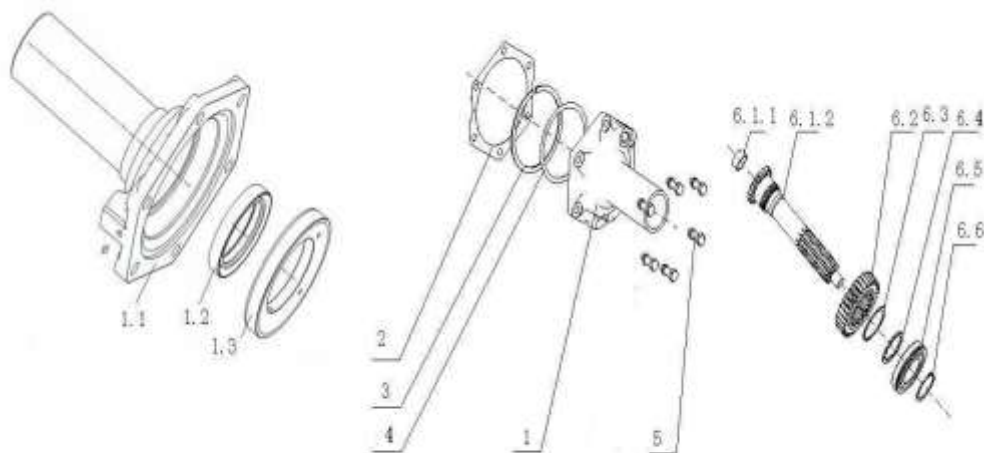

3.1.03 输入轴及端盖组件/Imput Shaft and Cover

序号 No.	零部件图号 Part No.	名称	Part Name	数量 Qty	备注 Remark
1	AZ2203020108	输入轴端盖及导油环总成	Ring ass.	1	
1.1	WG2203020002	输入轴端盖总成	Cover	1	From 20110107
1.2	WG9003070055	骨架油封PS 55 75 12	Sealing	1	From 20110107
1.3	WG2229020007	导油环	Oil ring	1	
2	WG2229020008	输入轴端盖纸垫	Paper gasket	1	
3	WG9003990120	止动环	Ring	1	From 20110107
4	AZ2208020002	输入轴承调整垫片组	Adjust shim unit	1	
4.1	WG2229020011	调整垫片	Shim	1	
4.2	WG2229020012	调整垫片	Shim	1	
4.3	WG2229020013	调整垫片	Shim	1	
5	Q150B1030	六角头螺栓	Screw	6	
6	AZ2203020013	输入轴及一轴齿轮总成	Imput shaft and 1st gear	1	
6.1	AZ2203020103	输入轴总成	Imput Shaft ass.	1	
6.1.1	WG2229020005	衬套	Bush	1	
6.1.2	WG2210020105	输入轴	Imput shaft	1	From 20110107
6.2	WG2210020222	一轴齿轮	Gear	1	From 20110107
6.3	WG2229040003	卡簧	Snap ring	1	
6.4	WG2229040103	隔套	Sleeve	1	
6.5	WG9003326213	滚动轴承	Roll bearing	1	From 20110107
6.6	AZ2208020001	卡簧选用件组	Optional snap ring unit	1	

3.1.03 输入轴及端盖组件/Imput Shaft and Cover

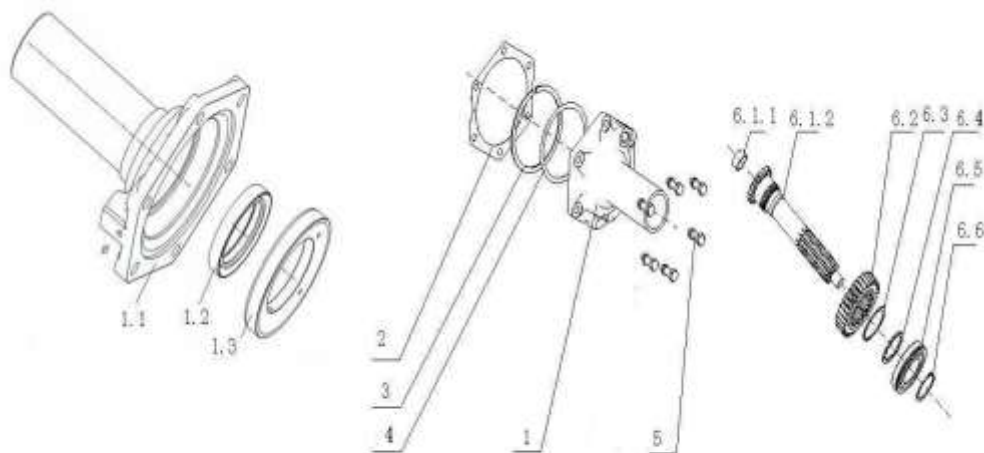

3.1.03 输入轴及端盖组件/Imput Shaft and Cover

序号 No.	零部件图号 Part No.	名称	Part Name	数量 Qty	备注 Remark
7	Q40310	弹簧垫圈	Washer	6	
8	WG9003991065	轴用弹性挡圈	Snap ring	1	From 20110107
9	WG9003992065	轴用弹性挡圈	Snap ring	1	From 20110107
10	WG9003993065	轴用弹性挡圈	Snap ring	1	From 20110107
11	WG9003994065	轴用弹性挡圈	Snap ring	1	From 20110107
12	WG9003995065	轴用弹性挡圈	Snap ring	1	From 20110107
	AZ2210020105	输入轴	Imput shaft	1	To 20110107
	AZ2210020222	一轴齿轮	Gear	1	To 20110107
	AZ9003326213	滚动轴承	Roll bearing	1	To 20110107
	AZ9003991065	轴用弹性挡圈	Snap ring	1	To 20110107
	AZ9003992065	轴用弹性挡圈	Snap ring	1	To 20110107
	AZ9003993065	轴用弹性挡圈	Snap ring	1	To 20110107
	AZ9003994065	轴用弹性挡圈	Snap ring	1	To 20110107
	AZ9003995065	轴用弹性挡圈	Snap ring	1	To 20110107
	AZ9003990120	止动环	Ring	1	To 20110107
	AZ2203020002	输入轴端盖总成	Cover	1	To 20110107
	WG2222020001	输入轴端盖	Cover	1	To 20110107
	AZ9003335500	钢球	Ball	1	To 20110107
	AZ9003070055	骨架油封	Sealing	1	To 20110107

3.1.04 副轴组件/Auxiliary Shaft

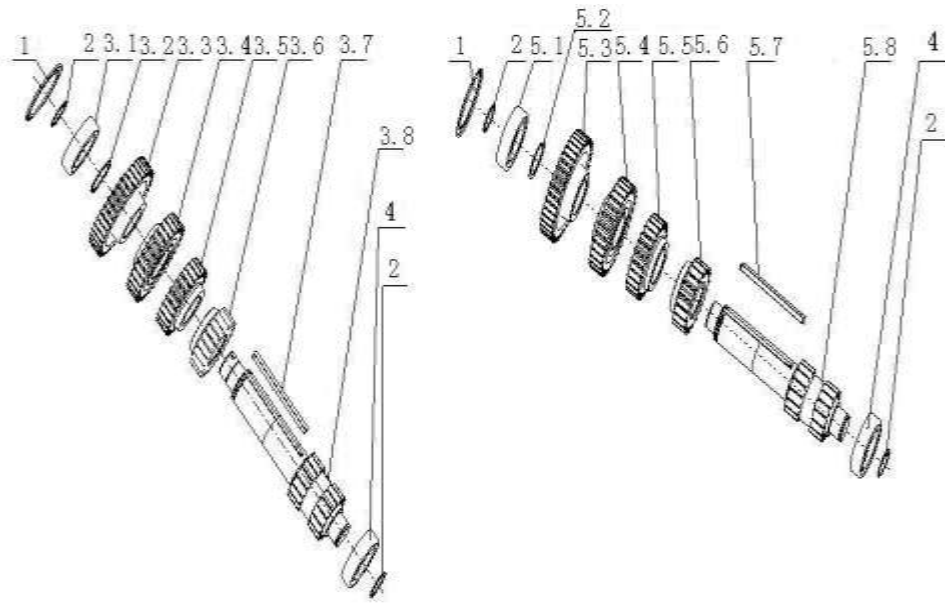

3.1.04 副轴组件/Auxiliary Shaft

序号 No.	零部件图号 Part No.	名称	Part Name	数量 Qty	备注 Remark
1	AZ9003990100	止动环	Ring	2	
2	Q43145	轴用弹性挡圈	Snap ring	4	
3	AZ2203030209	副轴总成(左)	Auxiliary shaft-left ass.	1	
3.1	WG9003329309	圆柱滚子轴承	Bearing	1	From 20110107
3.2	Q43160	轴用弹性挡圈	Snap ring	1	
3.3	AZ2210030227	副轴传动齿轮	Drive gear	1	
3.4	AZ2210030226	副轴四挡齿轮	4th gear	1	
3.5	AZ2210030224	副轴三挡齿轮	3rd gear	1	
3.6	AZ2210030203	副轴二挡齿轮	2nd gear	1	
3.7	WG2229030003	长平键	Key	1	From 20110107
3.8	AZ2210030220	副轴(左)	Auxiliary shaft-left	1	
4	WG9003320309	圆柱滚子轴承	Bearing	2	From 20110107
5	AZ2203030210	副轴总成(右)	Auxiliary shaft-right ass.	1	
5.1	WG9003329309	圆柱滚子轴承	Bearing	1	From 20110107
5.2	Q43160	轴用弹性挡圈	Snap ring	1	
5.3	AZ2210030227	副轴传动齿轮	Drive gear	1	
5.4	AZ2210030226	副轴四挡齿轮	4th gear	1	
5.5	AZ2210030224	副轴三挡齿轮	3rd gear	1	
5.6	AZ2210030203	副轴二挡齿轮	2nd gear	1	
5.7	WG2229030003	长平键	Key	1	From 20110107

3.1.05 主轴组件/Main Shaft

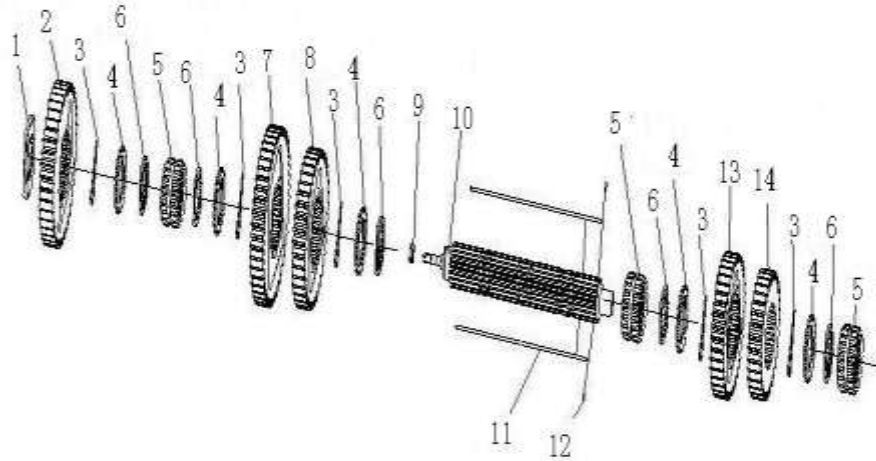

3.1.05 主轴组件/Main Shaft

序号 No.	零部件图号 Part No.	名称	Part Name	数量 Qty	备注 Remark
1	WG2210040002	主轴大挡片	Ring	1	
2	WG2210040207	主轴倒挡齿轮	R. gear	1	From 20110308
3	WG2229040003	卡簧	Snap ring	5	
4	WG2210040012	花键挡片	Spacer	5	
5	WG2210040210	主轴滑套	Slide sleeve	3	
6	AZ2208040001	花键调整片组	Adjust washer unit	1	
6.1	WG2210040021	花键调整片	Adjust washer	1	
6.2	WG2210040022	花键调整片	Adjust washer	1	
6.3	WG2210040023	花键调整片	Adjust washer	1	
6.4	WG2210040024	花键调整片	Adjust washer	1	
7	WG2210040230	主轴一档齿轮	1st gear	1	From 20110308
8	WG2210040206	主轴二档齿轮	2nd gear	1	From 20110308
9	AZ2208040002	主轴调整垫片组	Adjust washer unit	1	
9.1	WG2229040031	主轴调整垫片	Adjust washer	1	
9.10	WG2229040053	主轴调整垫片6.60	Adjust washer	1	
9.11	WG2229040054	主轴调整垫片6.75	Adjust washer	1	
9.12	WG2229040055	主轴调整垫片6.90	Adjust washer	1	
9.13	WG2229040056	主轴调整垫片7.05	Adjust washer	1	
9.2	WG2229040032	主轴调整垫片	Adjust washer	1	
9.3	WG2229040033	主轴调整垫片	Adjust washer	1	

3.1.05 主轴组件/Main Shaft

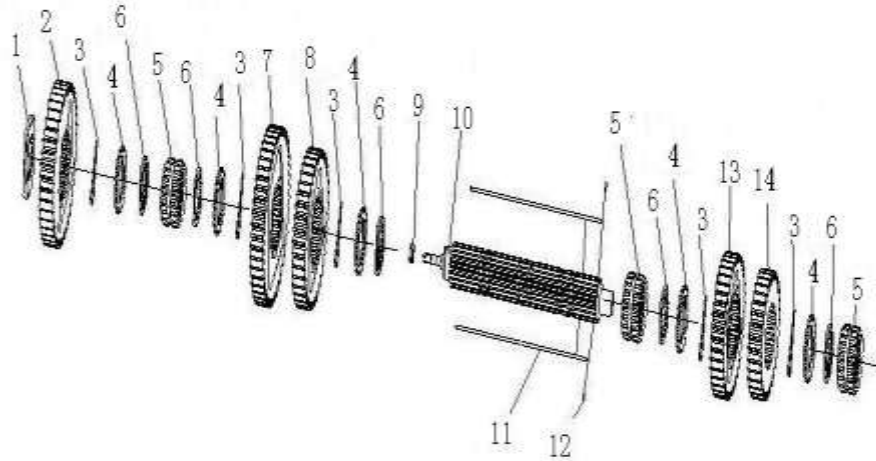

3.1.05 主轴组件/Main Shaft

序号 No.	零部件图号 Part No.	名称	Part Name	数量 Qty	备注 Remark
9.4	WG2229040034	主轴调整垫片	Adjust washer	1	
9.5	WG2229040035	主轴调整垫片	Adjust washer	1	
9.6	WG2229040036	主轴调整垫片	Adjust washer	1	
9.7	WG2229040037	主轴调整垫片 (6. 15)	Adjust washer	1	
9.8	WG2229040038	主轴调整垫片 (6. 30)	Adjust washer	1	
9.9	WG2229040039	主轴调整垫片 (6. 45)	Adjust washer	1	
10	WG2203040009	主轴带球头总成	Main shaft ass.	1	
11	WG2229040211	六角键	Key	2	
12	Q5280310	弹性圆柱销	Cylinder pin	2	
13	WG2210040225	主轴三挡齿轮	3st gear	1	
14	WG2210040224	主轴四挡齿轮	4st gear	1	
	AZ2203040405	主轴总成	Main shaft ass.	1	
	AZ2210040224	主轴四挡齿轮	4nd gear	1	To 20110308
	AZ2210040225	主轴三挡齿轮	3st gear	1	To 20110308
	AZ2210040206	主轴二挡齿轮	2th gear	1	To 20110308
	AZ2210040230	主轴一档齿轮	1st gear	1	To 20110308
	AZ2210040207	主轴倒档齿轮	R. gear	1	To 20110308

3.1.06 惰轮轴组件/Idle Wheel

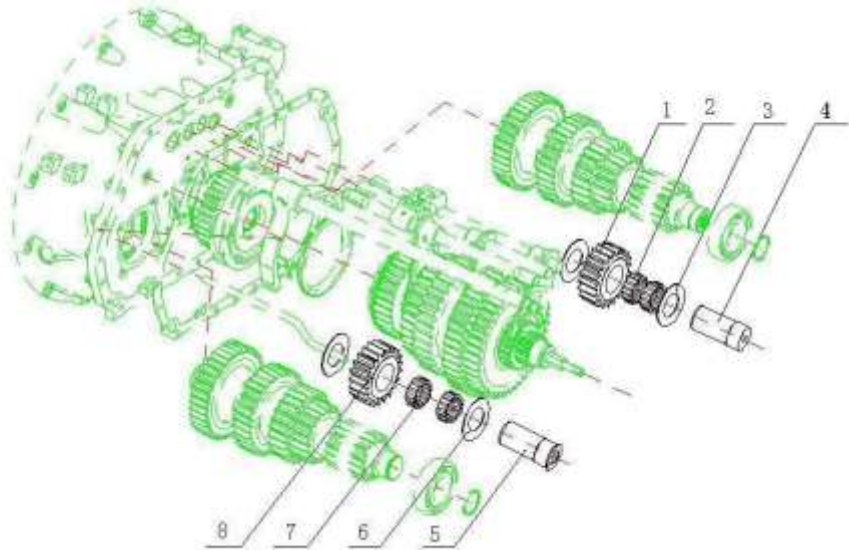

3.1.06 惰轮轴组件/Idle Wheel

序号 No.	零部件图号 Part No.	名称	Part Name	数量 Qty	备注 Remark
1	WG2210050001	惰轮	Idle gear	1	
2	WG9003395320	滚针轴承	Needle bearing	2	From 20110308
3	WG2229050001	垫片	Washer	2	
4	WG2212050102	惰轮轴(右)	Idle gear shaft-right	1	
5	WG2212050101	惰轮轴(左)	Idle gear shaft-left	1	
6	WG2229050001	垫片	Washer	2	
7	WG9003395320	滚针轴承	Needle bearing	2	From 20110308
8	WG2210050001	惰轮	Idle gear	1	
	AZ9003395320	滚针轴承	Needle bearing	2	To 20110308
	AZ9003395320	滚针轴承	Needle bearing	2	To 20110308

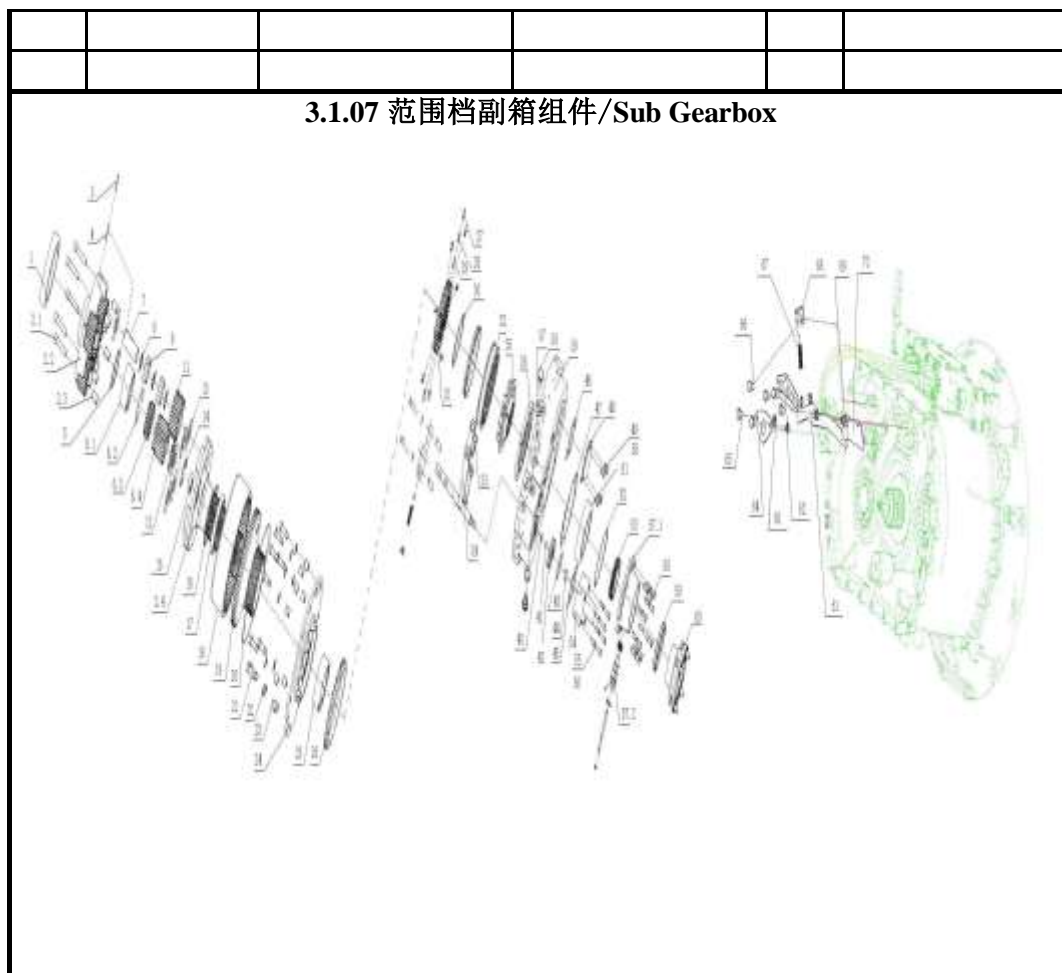

3.1.07 范围档副箱组件/Sub Gearbox

序号	零部件图号	名称	Part Name	数量	备注
No.	Part No.			Qty	Remark
1	WG9003326020	滚动轴承	Roll bearing	1	From 20110107
2	AZ2203100002	行星架总成	Planetary carrier	1	
2.1	WG9003821255	内六角圆柱头螺钉	Screw	5	From 20110107
2.2	WG2225100002	行星架（前）	Front carrier	1	
2.3	WG2229100001	传扭套	Sleeve	5	
2.4	AZ2225100001	输出轴	Output shaft	1	
3	Q5280630	弹性圆柱销	Spring cylinder pin	5	
4	Q5280430	弹性圆柱销	Spring cylinder pin	5	
5	WG2229100005	太阳轮垫片(前)	Washer	1	
6	AZ2203100003	太阳轮及套总成	Sun gear and sleeve	1	
6.1	WG2210100002	花键套	Sleeve	1	
6.2	Q43875	孔用钢丝挡圈	Ring	1	
6.3	WG2210100003	过渡套	Sleeve	1	
6.4	WG2210100001	太阳轮	Sun gear	1	
7	WG2212100001	行星轮轴	Planetary wheel	5	
8	WG2229100007	滚子间隔片	Spacer	15	
9	WG9003321118	圆柱滚子	Roller bearing	120	From 20110107
11	WG2210100004	行星轮	Planetary wheel	5	

12	WG2229100006	太阳轮垫片(后)	Washer	1	
13	WG2229100008	行星轮垫片	Washer	10	

3.1.07 范围档副箱组件/Sub Gearbox

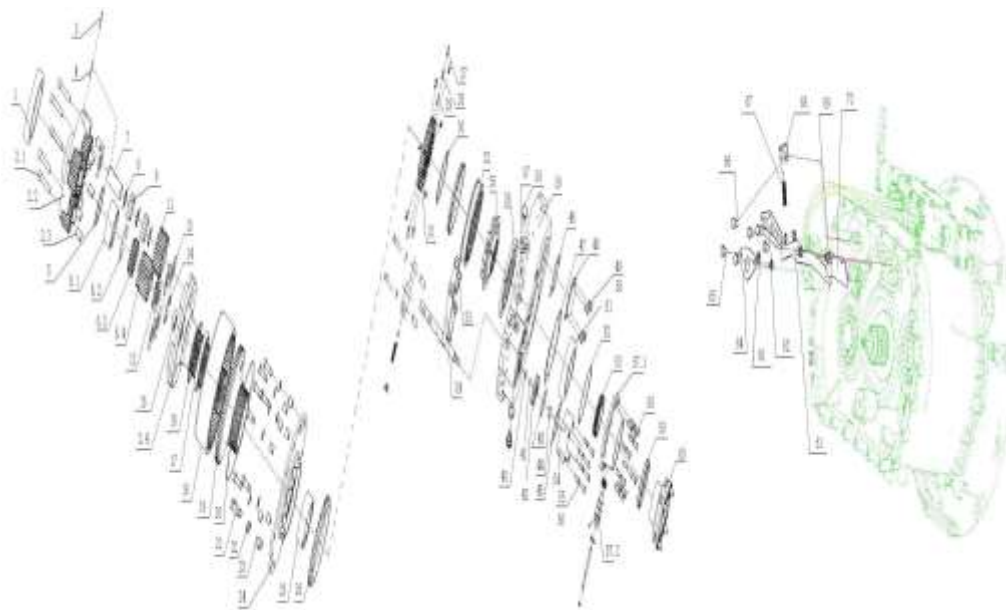

3.1.07 范围档副箱组件/Sub Gearbox

序号 No.	零部件图号 Part No.	名称	Part Name	数量 Qty	备注 Remark
14	WG9003991056	孔用弹性挡圈	Sanp ring	1	From 20110107
15	WG9003326322	滚动轴承	Roll bearing	1	From 20110107
16	WG9003991125	孔用压扁钢丝挡圈	Snap ring	1	
17	WG9003321820	滚动轴承	Roll bearing	1	From 20110107
18	WG2210100005	内齿圈	Gear ring	1	
19	WG2210100006	齿圈支架	Seat	1	
20	WG2229100012	钢丝挡圈	Ring	1	
21	Q150B1235	六角头螺栓	Screw	9	
22	Q40112	平垫圈	washer	9	
23	WG2229100002	传扭套	Sleeve	9	
24	WG2203100005	低档锥毂总成	Plate ass.	1	
25	WG2229100032	隔套	Sleeve	1	
26	WG2210100009	范围档同步环	Synchronizer ring	2	
27	WG2229020001	同步推块	Block	9	
28	WG2229020002	推块外弹簧	Spring	9	
29	WG2229020003	推块内弹簧	Spring	9	
30	WG9003991130	轴用弹性挡圈	Sanp ring	1	From 20110107
31	WG2210100007	范围档同步齿座	Seat	1	

32	WG221010008	范围档同步滑套	Slide sleeve	1	
33	WG2229100042	拨叉摆块	Block	2	

3.1.07 范围档副箱组件/Sub Gearbox

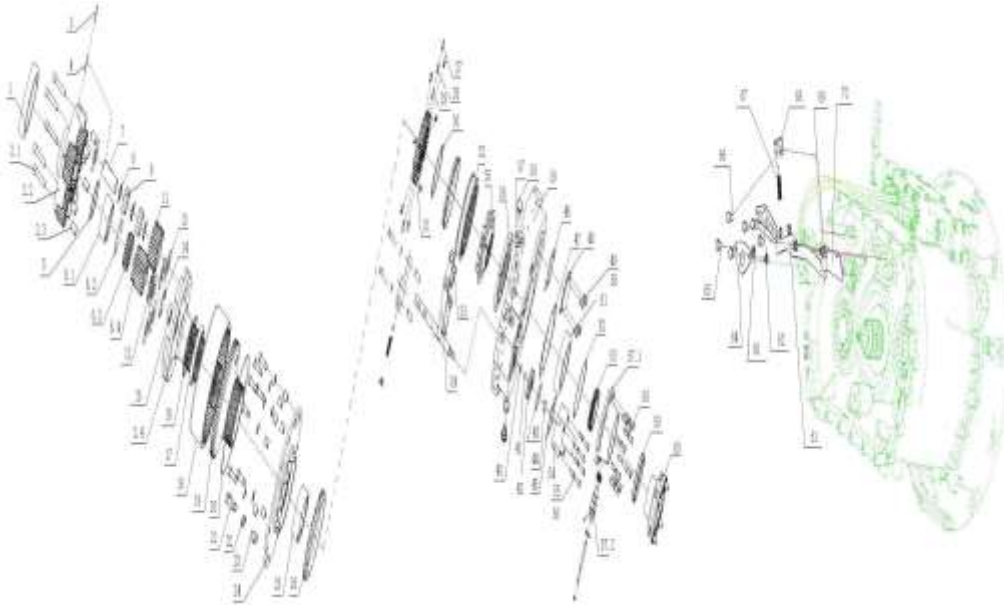

3.1.07 范围档副箱组件/Sub Gearbox

序号 No.	零部件图号 Part No.	名称	Part Name	数量 Qty	备注 Remark
34	WG2214100001	范围档拨叉	Yoke	1	
35	WG2203100006	高档锥毂总成	Plate ass.	1	
36	WG2203100007	导油环总成	Ring	1	
37	WG9003990024	波形弹性垫圈	Spring washer	2	From 20110107
38	WG2229100043	拨叉支撑销	Pin	2	
39	AZ2220100105	变速器后壳	Rear cover - gearbox	1	
40	WG9003072503	O形圈	O-ring	2	From 20110107
41	WG9003071700	O形圈	O-ring	1	From 20110107
42	WG2229100050	范围挡活塞	Piston	1	
43	WG9003076900	O形圈	O-ring	1	From 20110107
44	AZ9003870016	六角螺母M16×1.5	Nut	1	
45	WG2229100049	范围挡气缸纸垫	Joint	1	
46	WG2229100048	盖板衬垫	Joint	1	
47	WG2229100041	输出轴后端盖纸垫	Joint	1	
48	WG2229100047	取力轴孔盖板	Plate	1	
49	Q150B1216	六角头螺栓	Screw	4	
50	Q40312	弹簧垫圈	Spring washer	4	
51	WG9003326218	滚动轴承	Roll bearing	1	From 20110107

53	WG2210100015	里程表蜗杆	Worm	1	
54	WG2222100009	范围挡气缸	Cylinder	1	

3.1.07 范围档副箱组件/Sub Gearbox

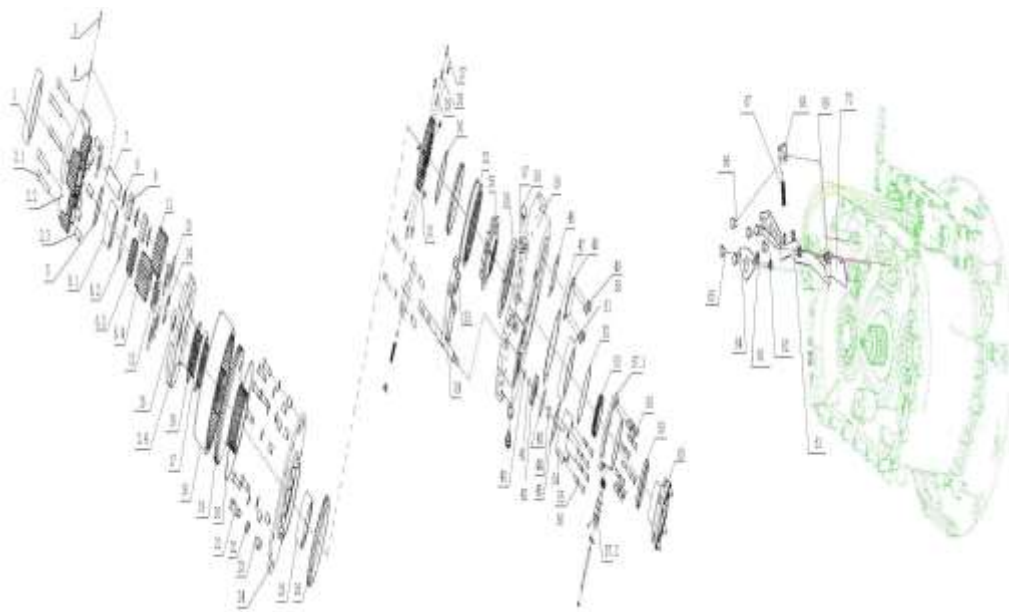

3.1.07 范围档副箱组件/Sub Gearbox

序号 No.	零部件图号 Part No.	名称	Part Name	数量 Qty	备注 Remark
55	Q150B1065	六角头螺栓	Screw	4	
56	Q40310	弹簧垫圈	Spring washer	4	
57	AZ2203100008	输出轴后端盖总成	Cover.ass	1	
57.1	WG2222100001	输出轴后端盖	Cover	1	
57.2	WG2203100009	里程表接头总成	Connection ass.	1	
58	Q150B1055	六角头螺栓	Screw	6	
59	AZ9003070105	骨架油封	Sealing	1	
60	WG2210100018	输出法兰Φ180端面齿	Flange	1	
61	WG2229100173	主副箱互锁板	Plate	1	
62	WG2229100174	锁板压板(大)	Plate	1	
63	WG2229100054	压板垫块	Plate	5	
64	WG2229100052	锁板压板(小)	Plate	1	
65	Q150B1025	六角头螺栓	Screw	5	
66	Q150B1020	六角头螺栓	Screw	1	
67	WG2229210019	范围档锁弹簧	Spring	1	
68	WG2203100012	弹簧定位销总成	Pin ass	1	
69	WG2229100056	锁板支销	Pin	1	
70	WG2229100175	锁板垫板	Plate	1	

72	AZ220810003	调整垫片组	Adjust shim	1	
72.1	WG2229100035	调整垫片	Adjust shim	1	

3.1.07 范围档副箱组件/Sub Gearbox

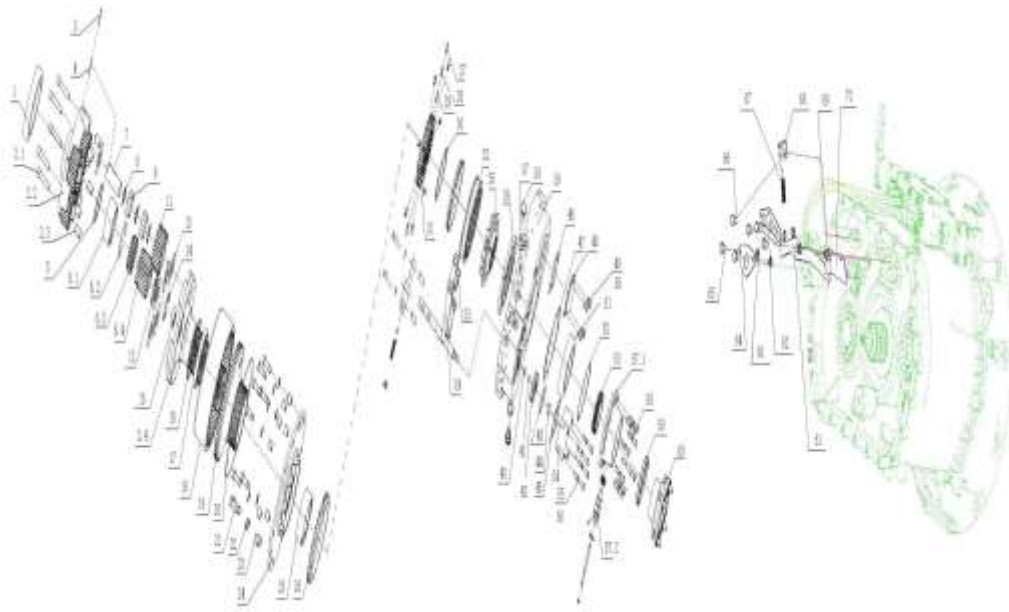

3.1.07 范围档副箱组件/Sub Gearbox

序号 No.	零部件图号 Part No.	名称	Part Name	数量 Qty	备注 Remark
72.2	WG2229100036	调整垫片	Adjust shim	1	
72.3	WG2229100037	调整垫片	Adjust shim	1	
73	Q170B1055	六角头头部带孔螺栓	Screw	1	
74	Q40310	弹簧垫圈	Spring washer	7	
77	WG2229100072	压板	Plate	1	
78	WG2229100073	螺栓	Screw	1	
80	Q150B0820	六角头螺栓	Screw	1	
81	AZ2229100075	回油孔盖板	Plate	1	
83	Q40310	弹簧垫圈	Spring washer	1	
85	WG2229100062	副箱纸垫	Joint	1	
86	WG2229100061	吊装板	Plate	1	
87	Q150B1050	六角头螺栓	Screw	16	
88	Q150B1060	六角头螺栓	Screw	6	
89	Q40310	弹簧垫圈	Spring washer	24	
90	WG2229100011	固定螺母	Nut	1	
91	WG2229100071	堵塞	Plug	1	
92	Q5280514	弹性圆柱销	Spring cylinder pin	1	
93	WG2229100074	锁片	Piece	1	

95	WG2214100002	范围档拨叉轴	fork shaft	1	
96	WG9003070800	O形圈18000800 GB3452.	O-ring	1	From 20110107

3.1.07 范围档副箱组件/Sub Gearbox

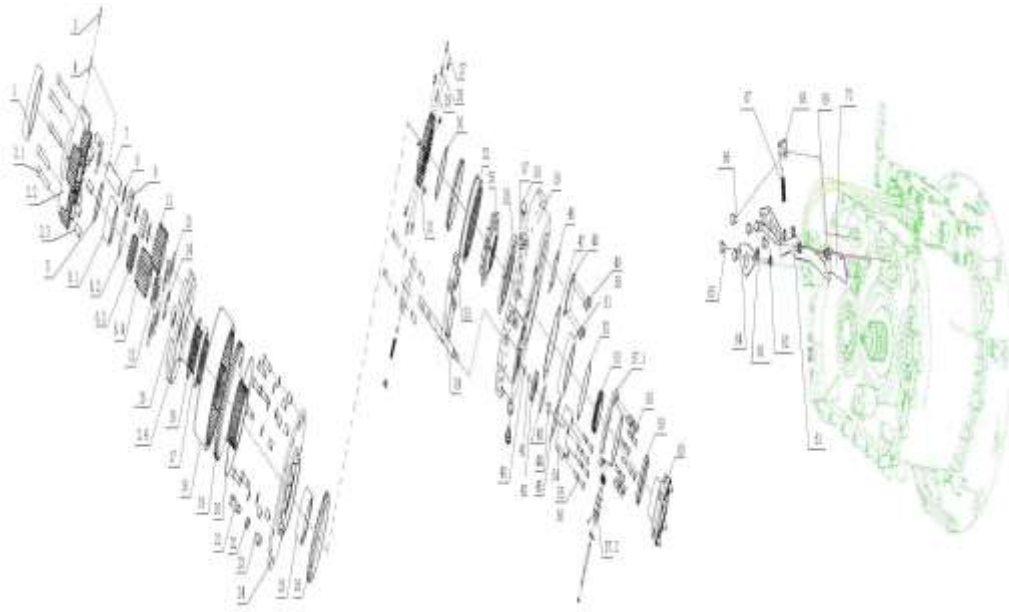

3.1.07 范围档副箱组件/Sub Gearbox

序号 No.	零部件图号 Part No.	名称	Part Name	数量 Qty	备注 Remark
97	WG9003801187	组合涂胶螺栓	Screw	1	
98	WG9003070800	O形圈	O-ring	1	From 20110107
99	WG9003801058	六角头螺栓	Screw	2	From 20110107
100	WG9003073150	O形圈	O-ring	1	From 20110107
	AZ2203100040	范围档副箱总成	Sub gearbox ass.	1	
	AZ9003821255	内六角圆柱头螺钉	Screw	5	To 20110107
	AZ9003321118	圆柱滚子	Roller bearing	120	To 20110107
	AZ9003326322	滚动轴承	Roll bearing	1	To 20110107
	AZ9003991056	孔用弹性挡圈	Sanp ring	1	To 20110107
	AZ9003321820	滚动轴承	Roll bearing	1	To 20110107
	AZ9003991125	孔用压扁钢丝挡圈	Snap ring	1	To 20110107
	AZ9003991130	轴用弹性挡圈	Sanp ring	1	To 20110107
	AZ9003326218	滚动轴承	Roll bearing	1	To 20110107
	AZ9003326020	滚动轴承	Roll bearing	1	To 20110107
	AZ9003070800	O形圈	O-ring	1	To 20110107
	AZ9003801187	六角头螺栓	Screw	1	To 20110107
	AZ9003990024	波形弹性垫圈	Spring washer	2	To 20110107
	AZ9003072503	O形圈	O-ring	2	To 20110107

3.1.08 小盖组件/Small Cover

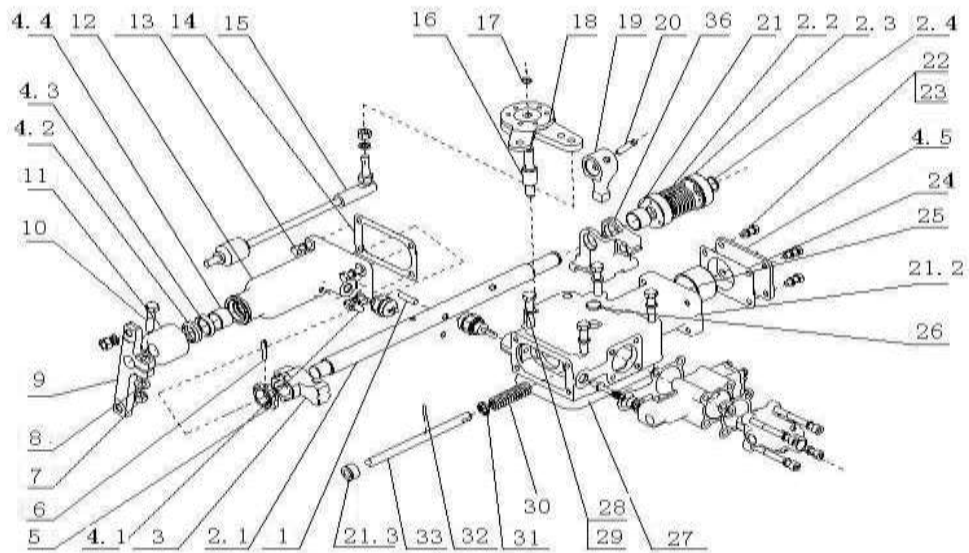

3.1.08 小盖组件/Small Cover

序号 No.	零部件图号 Part No.	名称	Part Name	数量 Qty	备注 Remark
1	WG2229210012	驱动销	Pin	1	
2	AZ2203210025	换挡轴总成	Shifting shaft	1	
2.1	WG2212210007	换挡轴(双杆)	Shifting shaft	1	
2.2	WG2229210021	定中弹簧(低档侧)	Spring	1	
2.3	AZ2229210007	定中座环	Ring	2	
2.4	Q43120	轴用弹性挡圈	Snap ring	1	
3	WG2229210008	扇形自锁块	Block	1	
4	AZ2203210008	小盖端盖总成(双杆)	Cover	1	
4.1	Q901	常开式通气塞	Plug	1	
4.2	WG9003072502	端盖外油封	Oil sealing - inside	1	
4.3	WG9003072501	端盖内油封	Oil sealing - outside	1	
4.4	WG2229002520	复合衬套	Sleeve	1	
4.5	WG2229210034	小盖端盖	Cover	1	
5	WG2229210014	传感器驱动环	Ring	1	
6	Q5280632	弹性圆柱销	Cylinder pin	1	
7	Q340B10T13F2	I型六角螺母	Nut	1	
8	Q41810	波形弹性垫圈	Washer	1	
9	WG2214210004	摇臂	Rocking arm	1	

10	Q150B1040TF2	六角头螺栓	Screw	1	
11	WG2229210026	防尘罩	Cover	1	

3.1.08 小盖组件/Small Cover

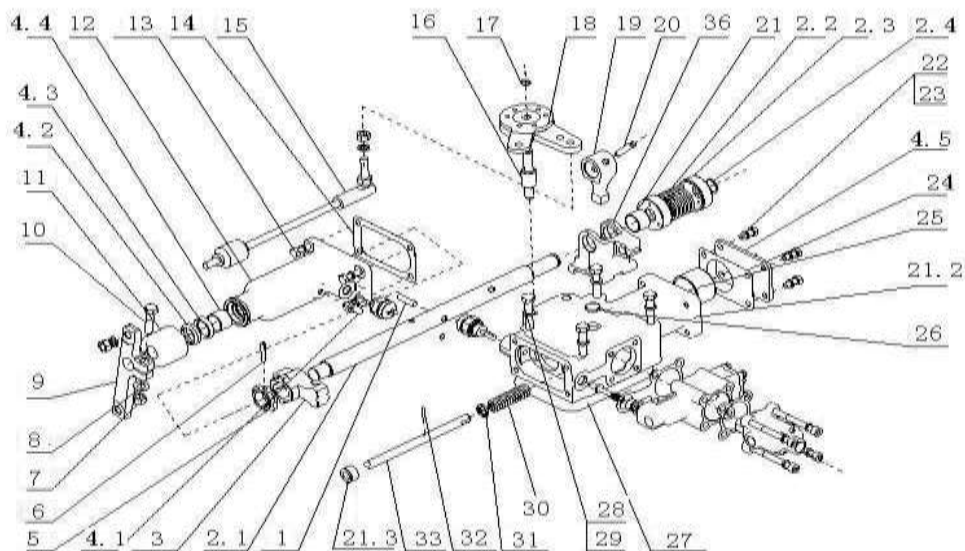

3.1.08 小盖组件/Small Cover

序号	零部件图号	名称	Part Name	数量	备注
No.	Part No.			Qty	Remark
12	Q40308	弹簧垫圈	Washer	4	
13	Q150B0825	六角头螺栓	Screw	4	
14	WG2229210017	端盖衬垫	Gasket	1	
15	WG2229210041	支撑杆总成	Support lever ass.	1	
16	WG2229270003	选档支撑轴	Shaft	1	
17	Q43112	轴用弹性挡圈	Snap ring	1	
18	WG2229210040	选档杆总成	Select gear lever ass.	1	
19	WG2214210103	换挡头	Block	1	
20	WG2229210009	销	Pin	1	
21	AZ2203210030	小盖壳体总成	House ass.	1	
21.1	WG2229002520	复合衬套	Sleeve	1	
21.2	WG2222210038	小盖壳体(10挡, 双杆)	House	1	
21.3	WG2229210001	衬套	Bush	1	
22	Q150B0820	六角头螺栓	Screw	4	
23	Q40308	弹簧垫圈	Washer	4	
24	WG2229210037	小盖端盖纸垫	Paper gasket	1	
25	WG2229210029	隔环	Spacer	1	
26	Q72220	碗形塞片	Core plug	1	

27	WG2229210050	小盖纸垫	Paper gasket	1	
28	Q150B1085	六角头螺栓	Screw	4	

3.1.08 小盖组件/Small Cover

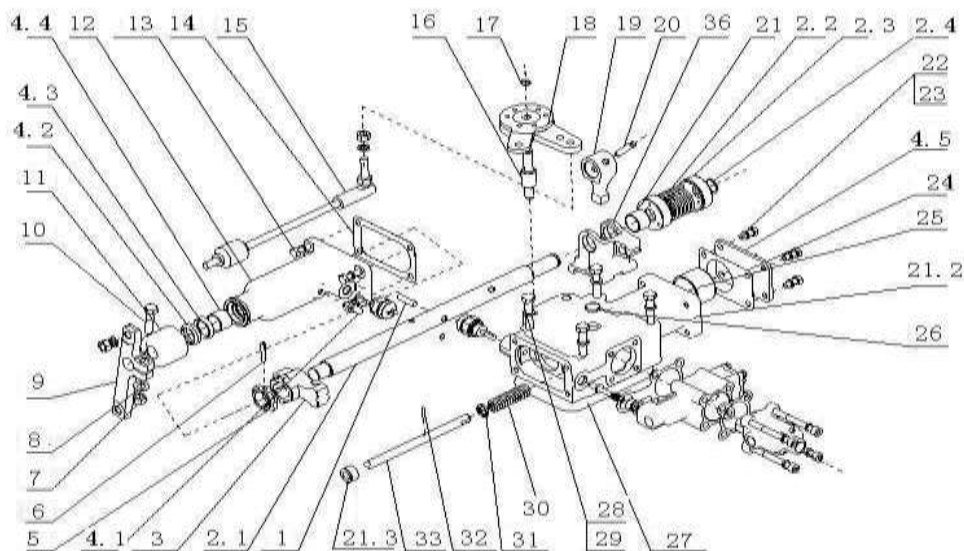

3.1.08 小盖组件/Small Cover

序号 No.	零部件图号 Part No.	名称	Part Name	数量 Qty	备注 Remark
29	Q40310	弹簧垫圈	Washer	4	
30	WG2229210033	自锁弹簧	Spring	1	
31	WG2229210011	弹簧挡片	Spacer	1	
32	AZ9003343178	滚针	Needle	1	
33	WG2212210005	自锁销轴	Shaft	1	
35	WG2222210034	小盖端盖(双杆摇臂侧)	Cover	1	
36	WG2214210010	互锁叉	Fork	1	
37	WG2229210036	定位导套	Sleeve	2	
38	AZ2203210040+001	10挡小盖总成(双杆)	Small cover ass.	1	From 20101125
	AZ2203210040	10挡小盖总成(双杆)	Small cover ass.	1	
	AZ2222210012	小盖壳体(10挡, 双杆)	House	1	To 20101125
	AZ2212210007	换挡轴(双杆)	Shifting shaft	1	To 20110107
	AZ2214210010	互锁叉	Fork	1	To 20110107
	AZ2214210103	换挡头	Block	1	To 20110107
	AZ2212210005	自锁销轴	Shaft	1	To 20110107
	AZ2229210033	自锁弹簧	Spring	1	To 20110107
	AZ2229210008	扇形自锁块	Block	1	To 20110107
	WG2222210003	小盖端盖(双杆摇臂侧)	Cover	1	To 20101125

3.1.09 拨叉轴组件/Fork Shaft

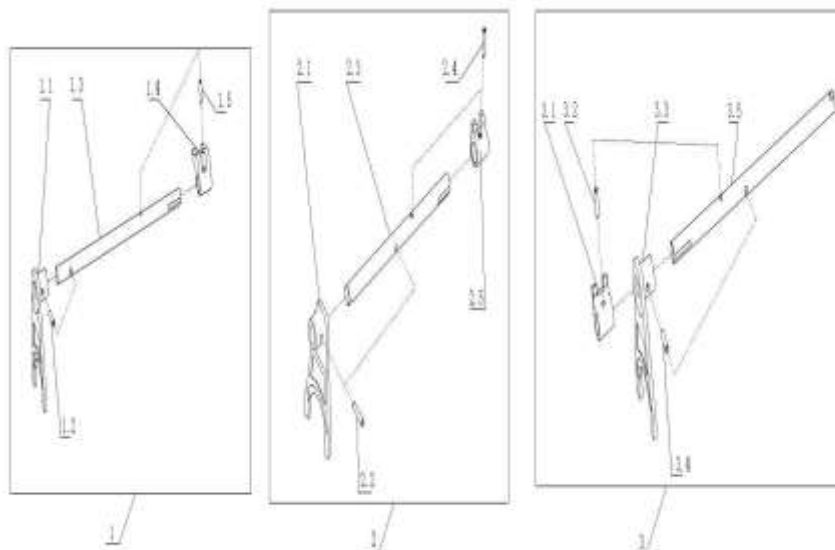

3.1.09 拨叉轴组件/Fork Shaft

序号 No.	零部件图号 Part No.	名称	Part Name	数量 Qty	备注 Remark
1	AZ2203220101	倒爬挡拨叉轴总成	Reverse gear fork shaft ass.	1	
1.1	WG2214220001	拨叉	Fork	1	
1.2	WG2229220002	销	Pin	1	
1.3	WG2212220201	倒爬挡拨叉轴	Reverse gear fork shaft	1	
1.4	WG2214220002	倒挡拨块	Block	1	
1.5	WG2229220001	销	Pin	1	
2	AZ2203220010	一、二挡拨叉轴总成	1st&2nd gear fork shaft ass	1	
2.1	WG2214220001	拨叉	Fork	1	
2.2	WG2229220002	销	Pin	1	
2.3	WG2212220102	一、二挡拨叉轴	1st&2nd gear fork shaft	1	
2.4	WG2229220001	销	Pin	1	
2.5	WG2214220004	前进挡拨块	Block	1	
3	AZ2203220103	三、四挡拨叉轴总成	3rd&4th gear fork shaft ass	1	
3.1	WG2214220003	前进挡拨块	Block	1	
3.2	WG2229220001	销	Pin	1	
3.3	WG2214220001	拨叉	Fork	1	
3.4	WG2229220002	销	Pin	1	
3.5	WG2212220103	三、四挡拨叉轴	3rd&4th gear fork shaft	1	

3.1.10 油泵及管路组件/Pump and Pipe

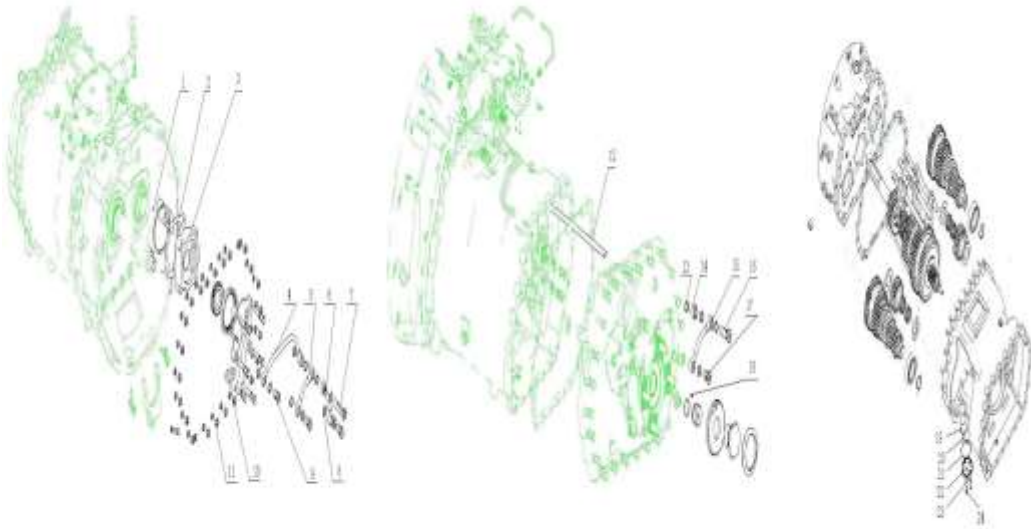

3.1.10 油泵及管路组件/Pump and Pipe

序号 No.	零部件图号 Part No.	名称	Part Name	数量 Qty	备注 Remark
1	WG9003338000	钢球	Ball	1	From 20110107
2	WG2229000002	副轴端盖衬垫	Gasket	1	
3	WG2203240005	油泵总成	Pump ass.	1	
4	WG2203240013	箱体进油管总成	Pipe ass.- oil in	1	
5	WG2203240012	输入轴进油管总成	Pipe ass.- oil in	1	
6	WG2203240011	出油管总成	Pipe ass.- oil out	1	
7	WG9003961670	空心螺栓	Female screw	1	
8	WG9004130016	组合密封垫圈	Washer	8	
9	190003962627	空心螺栓	Female screw	2	
10	WG2229240003	进油管纸垫	Paper gasket	1	
11	Q150B1070	六角头螺栓	Screw	4	
12	WG2229240108	箱内管2	Pipe	1	
13	WG9004130016	组合密封垫圈	Washer	5	
14	WG2229240010	衬套	Bush	1	
15	WG2203240014	副箱进油管总成	Pipe ass.- oil in	1	
16	WG9003961650	空心螺栓	Female screw	1	From 20110107
17	190003962627	空心螺栓	Female screw	1	
18	Q40310	弹簧垫圈	Washer	4	

19	WG2203240007	滤网总成	Filter net ass.	1	
20	WG9003070085	O形圈	O-ring	2	From 20110107

3.1.10 油泵及管路组件/Pump and Pipe

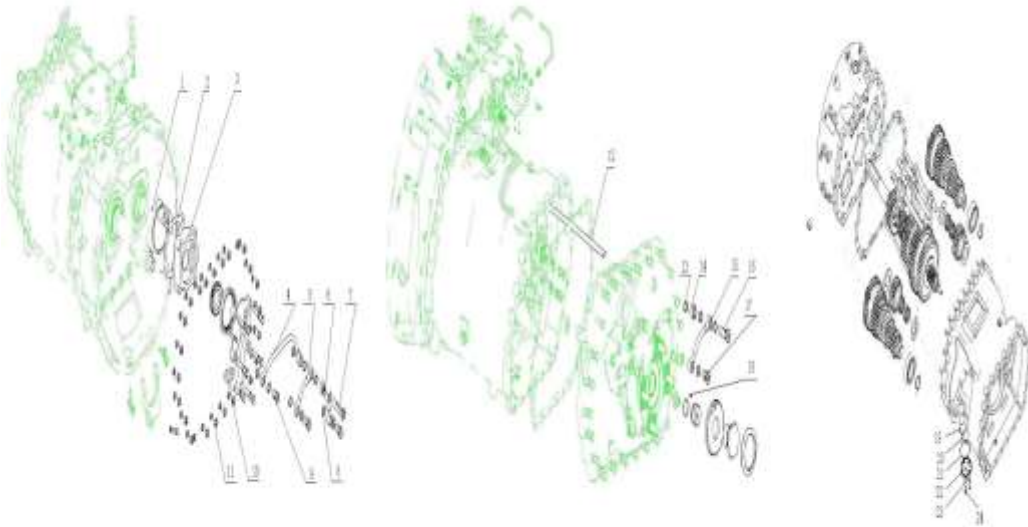

3.1.10 油泵及管路组件/Pump and Pipe

序号	零部件图号	名称	Part Name	数量	备注
No.	Part No.			Qty	Remark
21	WG9003077100	O形圈	O-ring	1	
22	WG2222240005	滤网端盖	Cover	1	
23	Q40308	弹簧垫圈	Washer	2	
24	Q150B0822	六角头螺栓	Screw	2	
25	Q40110	平垫圈	Washer	2	
27	Q150B1090	六角头螺栓	Screw	1	
28	Q150B1040	六角头螺栓	Screw	1	
29	190003962627	空心螺栓	Female screw	1	
30	WG2229240107	箱内管1	Pipe	1	
33	WG9004130016	组合密封垫圈	Washer	2	
	AZ2203240014	副箱进油管总成	Pipe ass.- oil in	1	
	AZ9003338000	钢球	Ball	1	To 20110107
	Q72316	密封垫圈	Washer	2	To 20110107
	AZ9003961670	空心螺栓	Female screw	1	To 20110107
	Q72316	密封垫圈	Washer	8	To 20110107
	AZ9003961650	空心螺栓	Female screw	1	To 20110107
	Q72316	密封垫圈	Washer	5	To 20110107
	AZ9003077100	O形圈	O-ring	1	To 20110107

	AZ9003070085	O形圈	O-ring	2	To 20110107

3.1.11 气动管路阀组件/Air Pipe and Valve

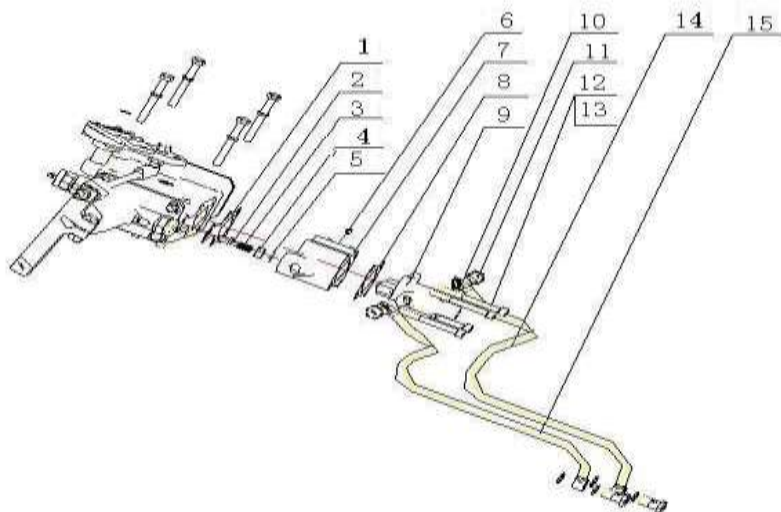

3.1.11 气动管路阀组件/Air Pipe and Valve

序号 No.	零部件图号 Part No.	名称	Part Name	数量 Qty	备注 Remark
1	WG2229250023	气控阀纸垫	Joint	1	From 20110107
2	WG2229250015	锁止销	Pin	1	From 20110107
3	WG2229250004	弹簧	Spring	1	From 20110107
4	WG2229250017	衬套	Bush	1	From 20110107
5	WG9003071700	O形圈	O-ring	1	From 20110107
6	WG2229250006	直通	Connector	1	
7	WG2203250010	气控锁止阀总成	Valve ass.	1	From 20110107
8	WG2229250024	双H阀衬垫	Gasket	1	From 20110107
9	WG2203250003	双H阀总成	Double "H" valve ass.	1	From 20110107
10	Q72314	密封垫圈	Washer	8	
11	190003962621	空心螺栓	Female screw	4	
12	Q218B0880	内六角圆柱头螺钉	Screw	4	
13	Q40308	弹簧垫圈	Spring washer	4	
14	WG2203250019	范围挡成型软管总成(高挡)	Hose ass.(highter gears)	1	
15	WG2203250018	范围挡成型软管总成(低挡)	Hose ass.(lower gears)	1	
	AZ2203250010	气控锁止阀总成	Valve ass.	1	To 20110107
	AZ2222250002	阀座	Seat	1	To 20110107

	WG9003072503	O形圈	O-ring	1	To 20110107
	AZ2229250020	弹簧	Spring	1	To 20110107

3.1.11 气动管路阀组件/Air Pipe and Valve

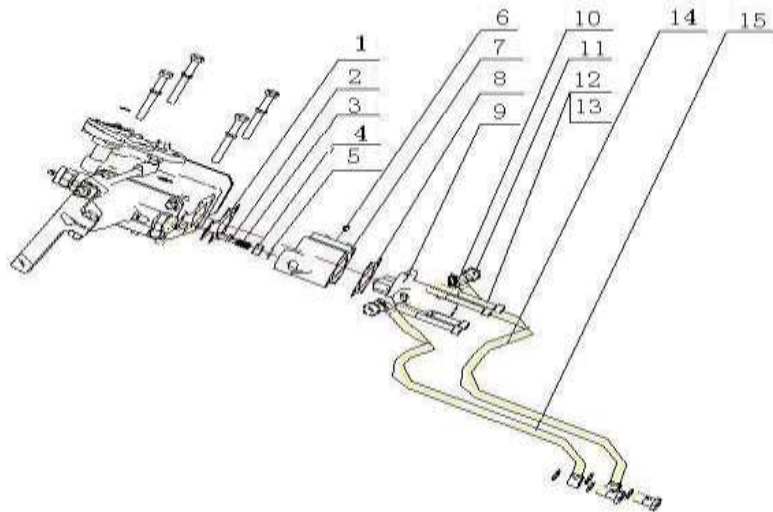

3.1.11 气动管路阀组件/Air Pipe and Valve

序号 No.	零部件图号 Part No.	名称	Part Name	数量 Qty	备注 Remark
	AZ2212250001	阀芯	Valve center.	1	To 20110107
	AZ9003070346	O形圈	O-ring	1	To 20110107
	AZ2222250001	阀盖	Cover	1	To 20110107
	Q40306	弹簧垫圈	Spring washer	4	To 20110107
	Q150B0630	六角头螺栓	Screw	4	To 20110107
	Q72116	塞片	Plug	1	To 20110107
	AZ2229250023	气控阀纸垫	Joint	1	To 20110107
	AZ2229250017	衬套	Bush	1	To 20110107
	AZ2229250015	锁止销	Pin	1	To 20110107
	AZ2229250004	弹簧	Spring	1	To 20110107
	AZ9003071700	O形圈	O-ring	1	To 20110107
	AZ2203250003	双H阀总成	Double "H" valve ass.	1	To 20110107
	AZ2229250024	双H阀衬垫	Gasket	1	To 20110107

3.1.13 电器开关组件/Electric Switchss

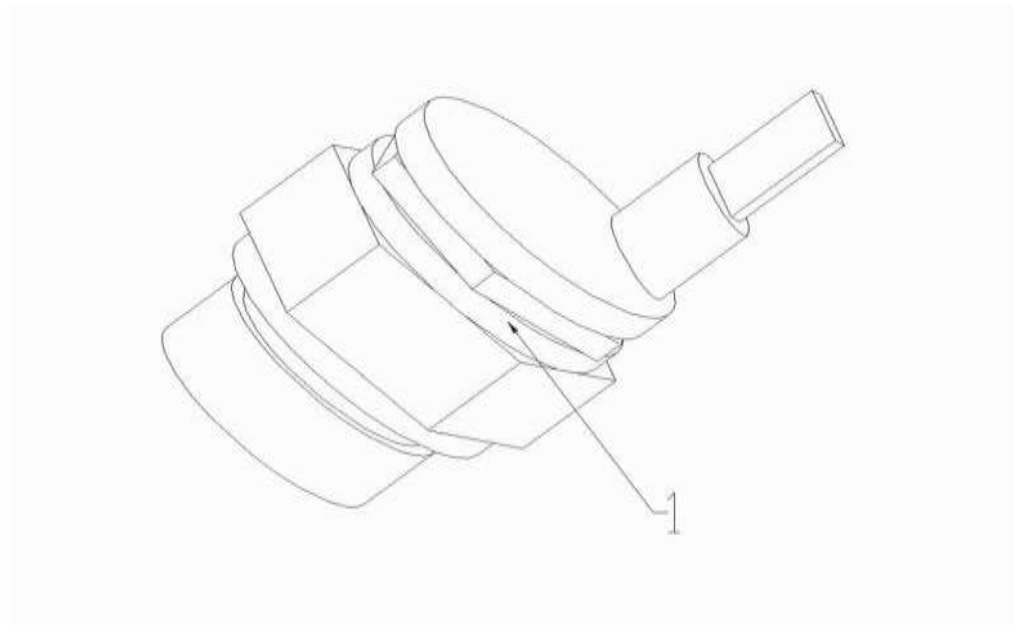

3.1.13 电器开关组件/Electric Switch

序号	零部件图号	名称	Part Name	数量	备注
No.	Part No.			Qty	Remark
1	WG9100710069	压力开关	Pressure switch	1	
2	WG2209280004	空挡压力开关(常闭)	Pressure switch(normally o	1	
3	WG2209280003	倒挡压力开关(常开)	Pressure switch(normally o	1	
4	WG2229280001	密封垫圈	Washer	2	
	179100710069	压力开关(KOSTAL厂)	Pressure switch	1	To 20110308
	199012710041	压力开关(信号开关)	Pressure switch	1	To 20110308
	179100710068	压力开关(messmer厂订	Pressure switch	2	To 20110308
	WG2229210027	空档传感器顶销	Pin	1	To 20110308
	AZ2203210006	传感器顶销总成	Pin	2	To 20110308
	WG2229210028	传感器顶销	Pin	1	To 20110308
	Q43708	轴用钢丝挡圈	Spacer	1	To 20110308

